

CATER-PREP

CATER-PREP CK0853 HEAVY DUTY MEAT GRINDER MANUAL

*Please read this manual carefully prior to use
& keep it in a convenient place for future reference.*

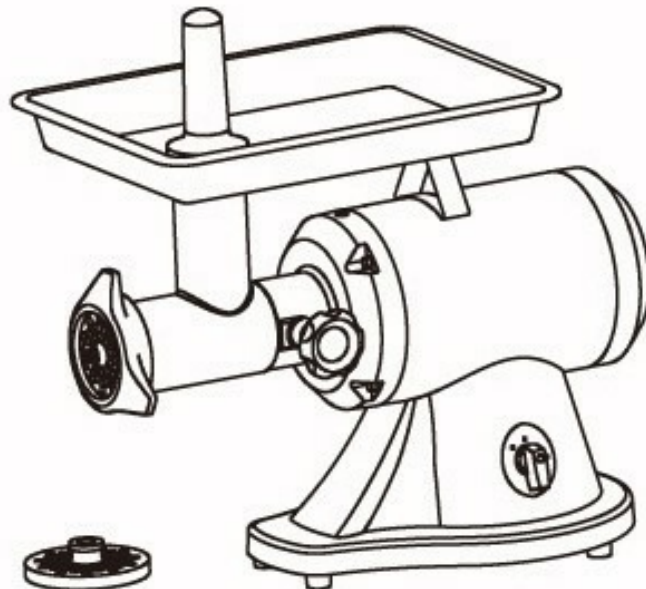

CATER KWIK, The Lakeland Catering Centre, Newlands, Ulverston, Cumbria, LA12 7QQ
Tel: 01229 480001 | E-mail: INFO@CATERKWIK.CO.UK

CATER-KWIK

Contents

Thank you for purchasing a Cater-Prep machine. In order to ensure safe operation, you are advised to read to this manual carefully to fully understand the features, operating instructions & maintenance details of this equipment.

	Page
<u>Contents:</u>	2
Safety Notice	3
Assembly	4
Specifications	5
Notes	6-7



Safety Notice

- Unplug when assembling or disassembling the unit.
- Make sure that the power cord is away from sharp edges or hot appliances.
- Supervise children carefully when near this appliance.
- Hold the motor housing up when carrying.
- Be careful when carrying the unit due to the weight of this appliance.
- Never feed food into the machine by hand, use the food pusher.
- Do not grind hard foods such as bones and nuts.
- Do not grind ginger or other materials with hard fibre.
- To avoid jamming do not force operate the unit with excessive pressure.
- If the unit jams do not continue to feed food into this turn this off and immediately clean the unit.
- Never try to undo parts or to repair the unit by yourself, this must be repaired by a approved Cater-Prep engineer .

If the minced meat doesn't discharge smoothly or discharges in the form of paste, it is likely:

- The Screw cap is loosened to much thus the cutting blade fails to connect with the cutting plate.
- The cutting plate is blocked thus requiring cleaning.
- The cutting blade needs to be replaced.

Assembly

Below is the instructions for assembly of the meat grinder:

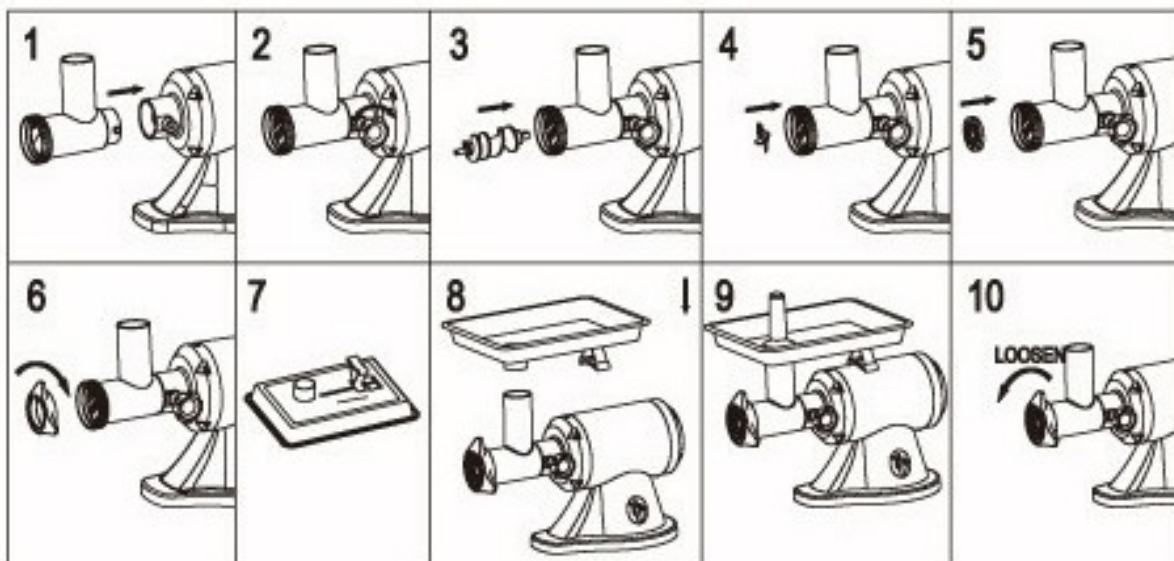
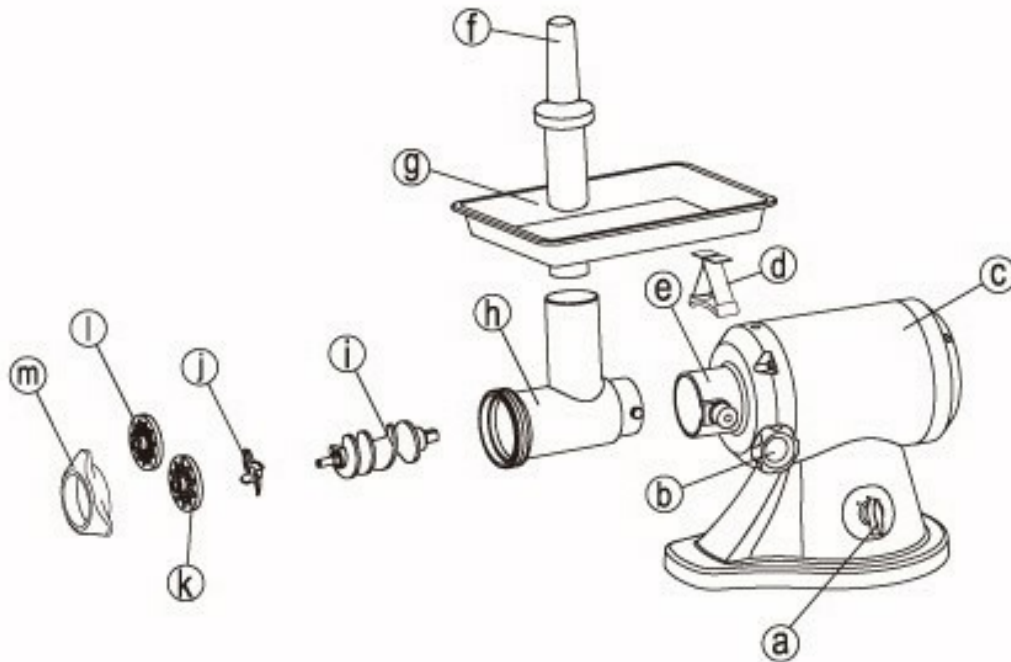

- | | | | |
|------------------|-------------------|------------------|---------------------------|
| A. Switch | D. Hopper Bracket | H. Head | K. Cutting plate (Coarse) |
| B. Locking knob | F. Food pusher | I. Food Screw | L. Cutting Plate (Medium) |
| C. Motor housing | G. Hopper Plate | J. Cutting Blade | M. Screw Cap. |

Specifications

Power 1100W 220V

Size 246 x 268 x 558 with foot pedal.

Weight 35KG.

NOTES

[illegible]

NOTES

[illegible]